

MF-30

MECHANICAL FILTER

The MF-30 is a flexible and expandable mechanical filter designed to extract welding fumes and other dry dust. This wall-mounted filter is used for light-duty welding or maintenance applications.

The mechanical filter also comes in a free-standing version, the MF-31.



APPLICATIONS

The MF-30 is intended to be used for the following applications:

- Extraction of welding fumes in light duty or maintenance applications.



- MIG-MAG/GMAW welding
- TIG welding
- FCAW welding
- stick/MMAW welding
- Stainless steel welding
- Grinding
- Polishing
- Finishing

SPECIFICATIONS

Physical dimensions and properties

Material (housing):	<ul style="list-style-type: none"> • steel grade • steel grade no. 	<ul style="list-style-type: none"> • Galvanized steel • Epoxy powder coat
Colour	Light gray and jet black.	
Weight (net)	49 kg (108 lbs)	

Filter

Filter Elements	<ul style="list-style-type: none"> • Stage 1 • Stage 2 • Stage 3 	<ul style="list-style-type: none"> • Spark arrestor • Pre-filter • Aluminium mesh • Fine filter, glass fibre GFMF 95% ASHRAE/F9 EuroVent/BIA-C
-----------------	---	--

Final filter pressure: 800 Pa (3.2" wg)

Performance

Air Volume	2 x 800 - 1200 m ³ /h (2 x 470 - 700 CFM)
Max. negative pressure	4000 Pa (16" wg)
Filter indicator	Manometer 0-200 Pa (0-8" wg)

Ambient conditions

Process temperature:	<ul style="list-style-type: none"> • min. • nom. • max. 	<ul style="list-style-type: none"> • 5°C (41°F) • 20°C (68°F) • 70°C (158°F)
Max. relative humidity	90%	
Suitable for outdoor use	no	
Storage conditions	<ul style="list-style-type: none"> • 5-45°C (41-113°F) • relative humidity max. 80% 	

Product combinations

Plymovent 160 mm (6.3 in.) KUA and EA-arms.

Order information

Article no.	0000102582
Number/package	1

Logistics data

Gross weight (incl. pallet)	55 kg (120 lbs)
Packing dimensions (incl. pallet)	100x80x140 cm
Max. number/pallet	1

DIMENSIONS

Front view

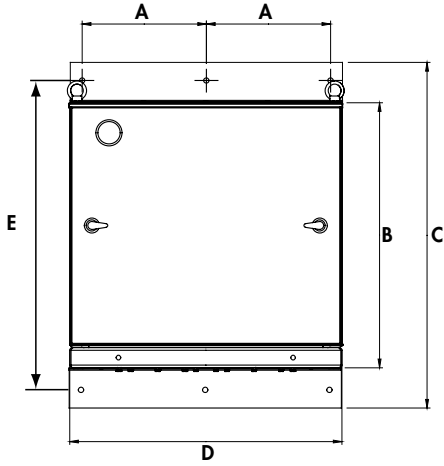

Top view

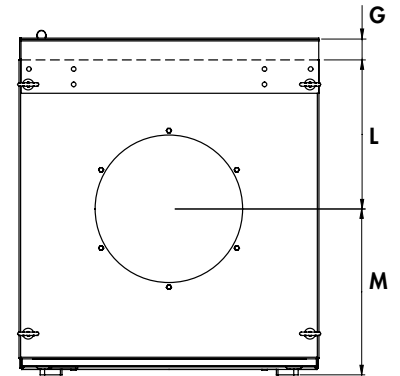

Side view

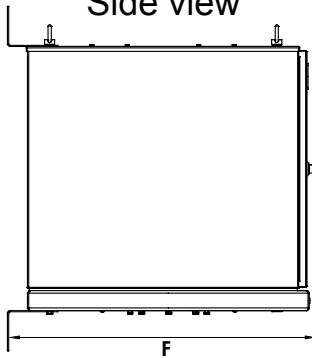

Bottom view

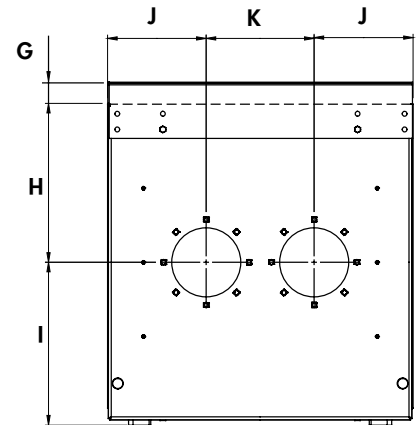

	mm	inch
A	308	12 1/8
B	657	25 7/8
D	675	26 9/16
E	767	30 3/16
F	760	29 29/32
G	50	2
H	354	13 29/32
I	362	14 1/4
J	220	8 11/16
K	240	9 7/16
L	340	13 3/8
M	376	14 13/16

APPROVALS/CERTIFICATES

	Directive 2011/65/EC (RoHS) valid as of 8 June 2011

Application restrictions

Do **not** use the product for the following applications or in the following circumstances: polishing applications in combination with grinding, welding or any other application that generate sparks (fibres from polishing or abrasive flap disks are highly flammable and pose a high risk of filter fires when exposed to sparks) | aluminium laser cutting | oil mist | heavy oil mist in welding fume | arc-air gouging | extraction of aggressive fumes and gases (e.g. from acids, from alkaline, from soldering paste containing lithium) | extraction of hot gases (more than 70°C/158°F continuously) | grinding aluminum and magnesium | flame spraying | extraction of cement, saw dust, wood dust etc. | sucking cigarettes, cigars, oiled tissues and other burning particles, objects and acids | explosive environments or explosive substances/gases



Product type
Article no.
Product category
Version

Mechanical Filter MF-30
0000104758
Stationary filters
26APR2023/B

Always check the latest version on www.plymovent.com